

**Winnebago County, IL
GPS PROJECT 2000**

Station Name WIN 00.2N-09.0E^A Station No. 18A

Section 33, Town 43 North, -Range 2 (East) / West

Town of Cherry Valley, County Winnebago, State Illinois

Observer E. Lindaas; Date of observation 3 Nov. 2000

Order of Control 1ST -Meters -Feet Zone: IL WEST

County Coordinates: N: 609182.414 LAT: 42 08 52.82652 N

E: 796580.909 LON: 88 59 53.42338 W

H. Datum: NAD 83/91 E: 255.160 LON: 221.980 GH '99 -33.18

V. Datum: NAVD 88 ELEV: ELLIP

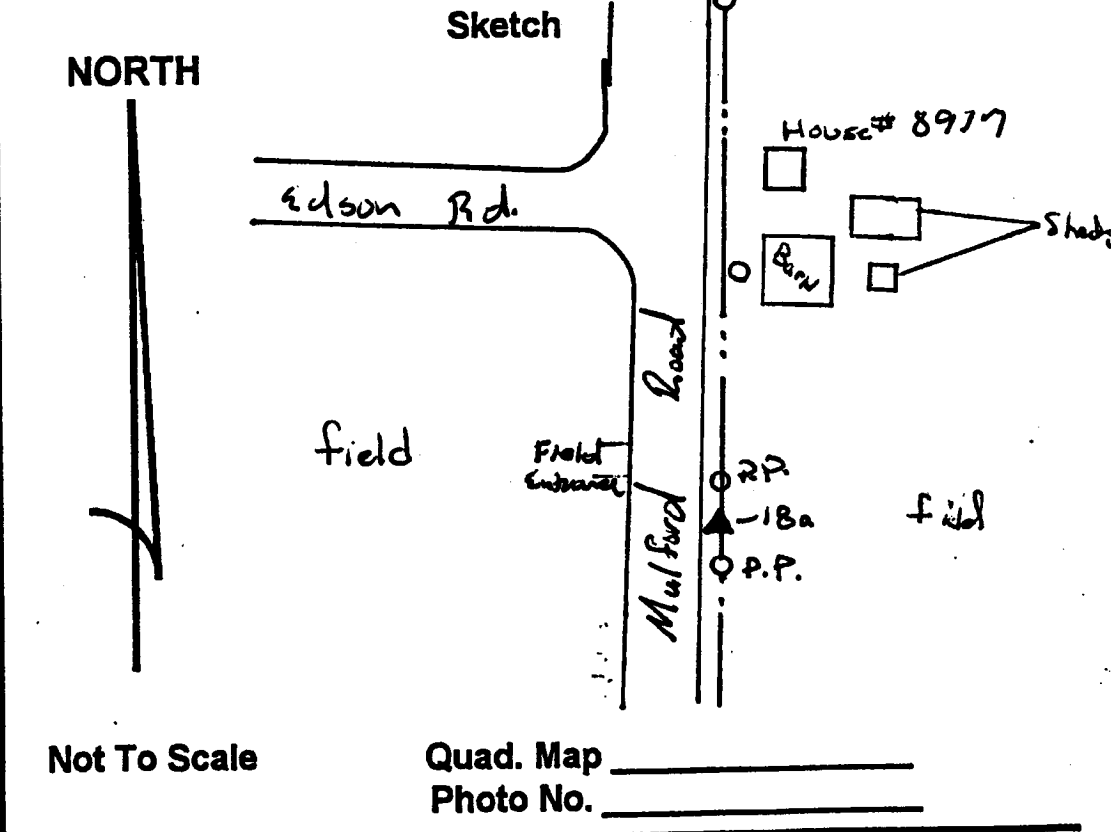
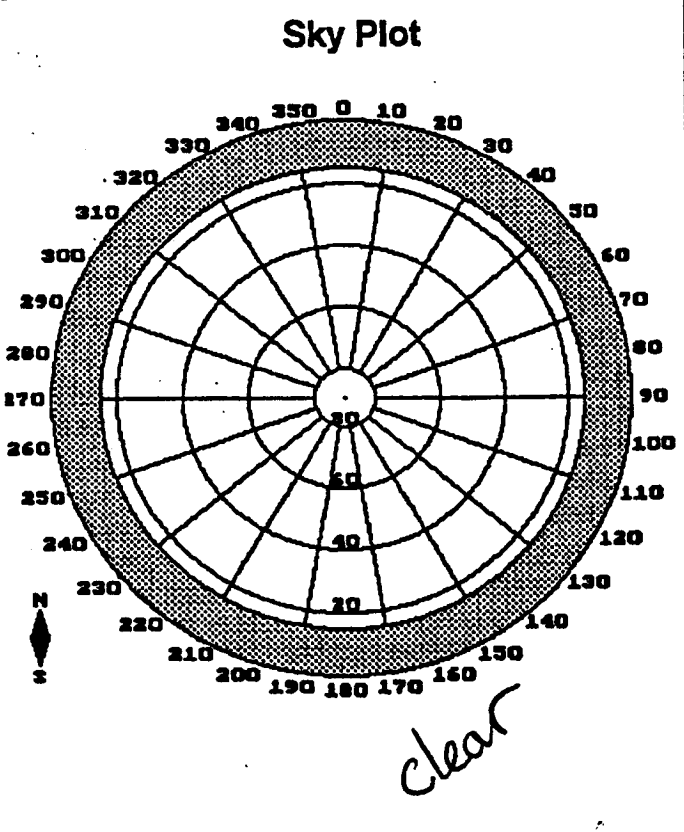
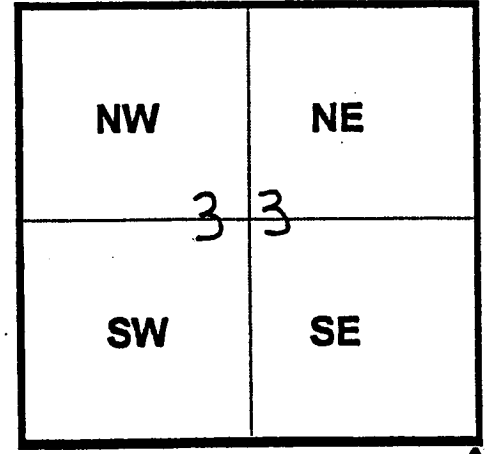

DESCRIPTION: Steel Rod & Al Cap located 0.25 mile South of EE Edson Rd & Mulford Rd; 55 ft North of P.P#(None); 20 ft East of East edge of bit; 0.9 ft North of conc. ROW marker; 1' West of orange witness post. Cap at ground level.