

**Winnebago County, IL
GPS PROJECT 2000**

Station Name Win 12.8N-08.7E Station No. 22

Section 33, Town 45 North, Range 2 East / ~~West~~

Town of HARLEM, County Winnebago, State Illinois

Observer E. SANDSUE; Date of observation 17 OCT 2000

Order of Control 1ST Meters Feet Zone: IL WEST

County Coordinates: N: 629947.533 LAT: 42 20 06.11265 N

H. Datum: NAD 83/91 E: 795688.327 LON: 89 00 19.97131 W

V. Datum: NAVD 88 ELEV: 261.110 ELLIP 227.660 GH '99 -33.45

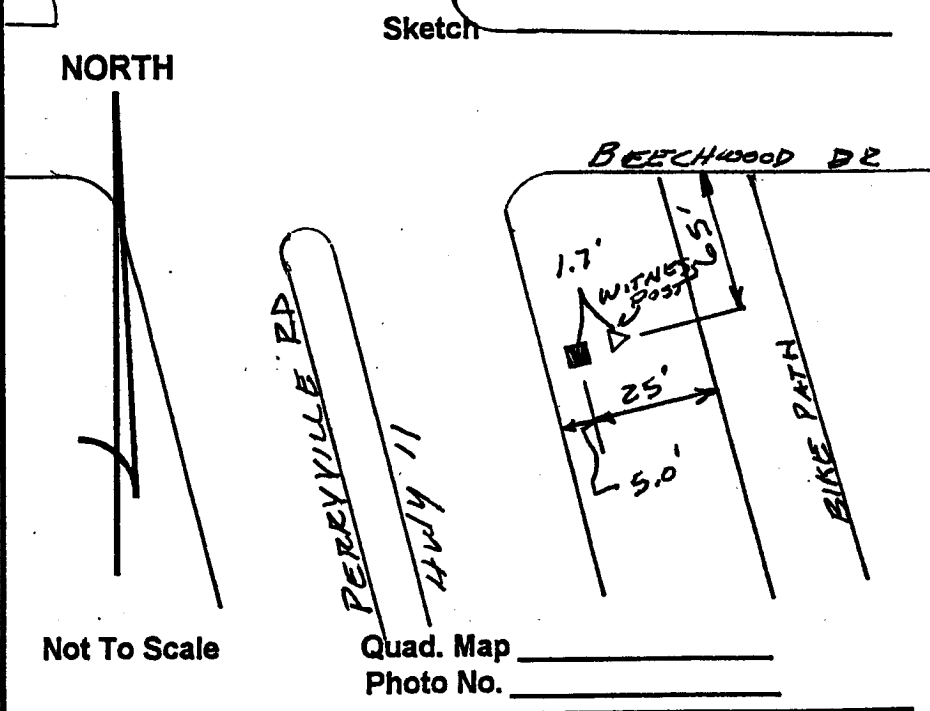
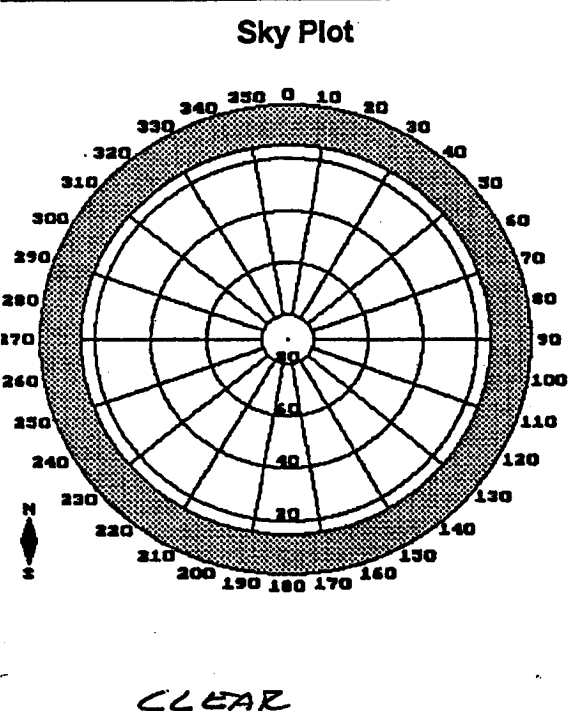
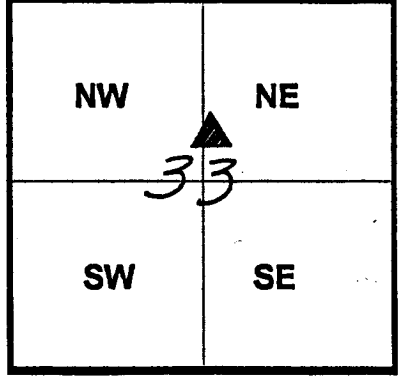

DESCRIPTION: SET STEEL ROD IN ACCESS BOX FLUSH WITH SURFACE;
STATION IS LOCATED AT INTERSECTION OF BEECHWOOD DRIVE
AND Hwy 11 (PERRYVILLE RD); LOCATED IN SOUTHEAST QUADRANT
5.0 FEET EAST OF NORTH BOUND LAND AND 65 FEET SOUTH OF
SOUTH EDGE OF PAVEMENT OF BEECHWOOD DRIVE, 1.7 FEET
WEST OF WITNESS POST; 25 FEET WEST OF BIKE PATH