

Winnebago County, IL  
GPS PROJECT 2000

Station Name WIN03.1N-07.7E Station No. 26 A

Section 17, Town 43 North, Range 2 East / West

Town of Cherry Valley, County Winnebago, State Illinois

Observer E. Lindas; Date of observation 3 November 2000

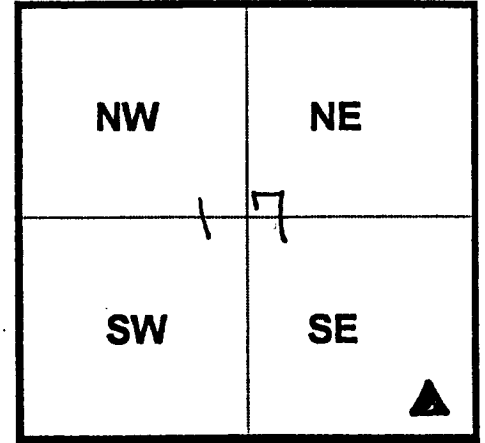

Order of Control 1<sup>ST</sup>  -Meters  -Feet Zone: IL WEST

County Coordinates: N: 614854.395 LAT: 42 11 57.48352 N

H. Datum: NAD 83/91 E: 794636.377 LON: 89 01 14.78388 W

V. Datum: NAVD 88 ELEV: 256.000 ELLIP 222.770 GH '99 -33.23

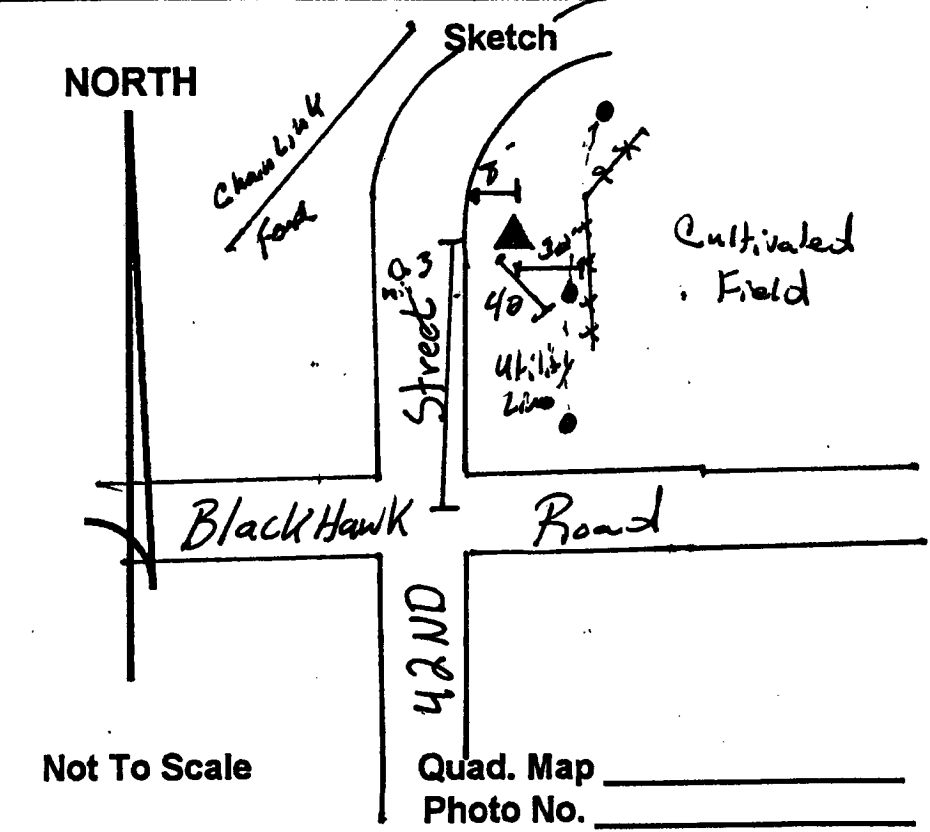
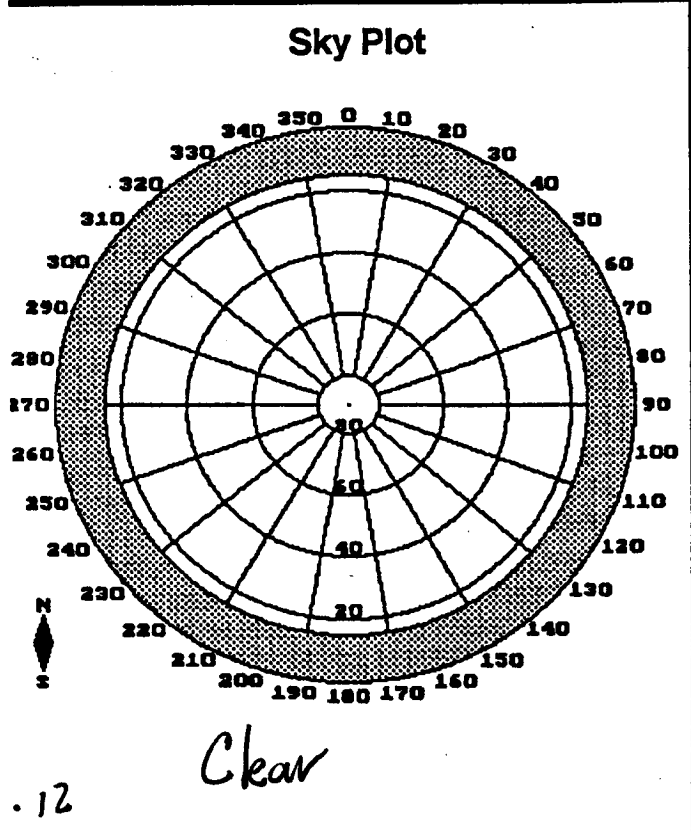

DESCRIPTION: station is 30 feet west of Barbed wire fence, 40 feet (NW) of utility pole "R8-893." 8 feet east of the East EOP of 42ND Street and 1 foot west of an orange car's white witness post. Station is 0.3 miles North of BlackHawk Road.