

**Winnebago County, IL
GPS PROJECT 2000**

Station Name WIN 14.9N-07.2E Station No. 0030

Section 20, Town 45 North, -Range 1 (East) West

Town of HAZLEM, County Winnebago, State Illinois

Observer D. MUENZI; Date of observation 10.17.2000

Order of Control 1ST -Meters - Feet Zone: IL WEST

County Coordinates: N: 633332.104 LAT: 42 21 56.85590 N

H. Datum: NAD 83/91 E: 793243.665 LON: 89 02 04.77519 W

V. Datum: NAVD 88 ELEV: 223.210 ELLIP 189.710 GH '99 -33.50

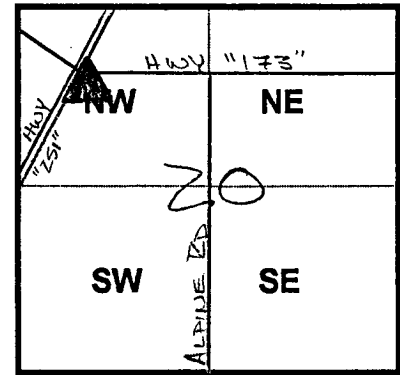

Sky Plot

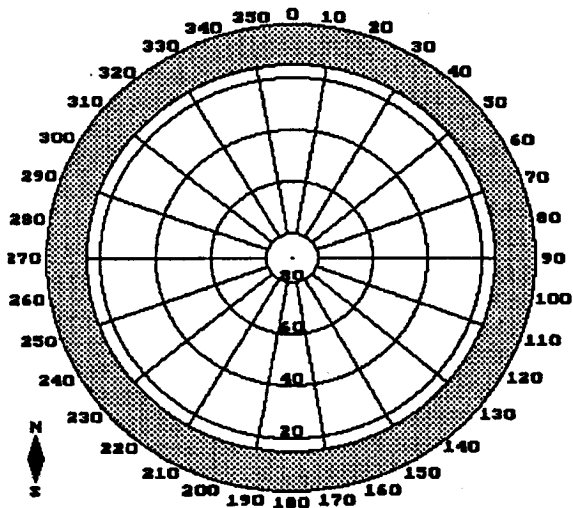

NORTH



Not To Scale

Sketch

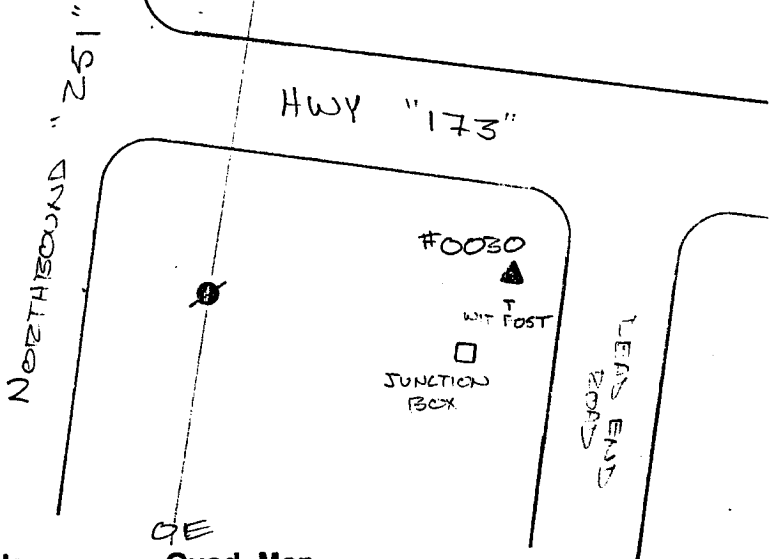

Quad. Map _____
Photo No. _____

DESCRIPTION: POINT 0030 IS A STAINLESS STEEL ROD SET 0.05' BELOW
GROUND IN A HAND-HOLE. LOCATED 252' S/O HWY "173", 2155' E/O
THE NORTHERN HWY "251", 220' NNE/O A JUNCTION BOX, 1' N/O A
CARBONITE WITNESS POST.