

**Winnebago County, IL  
GPS PROJECT 2000**

Station Name WIN 18.6N-11.9E A Station No. 3A

Section 36, Town 46 North, Range 02 (East)/~~West~~

Town of Roscoe, County Winnebago, State Illinois

Observer E. Lixdaas; Date of observation 13-Nov.

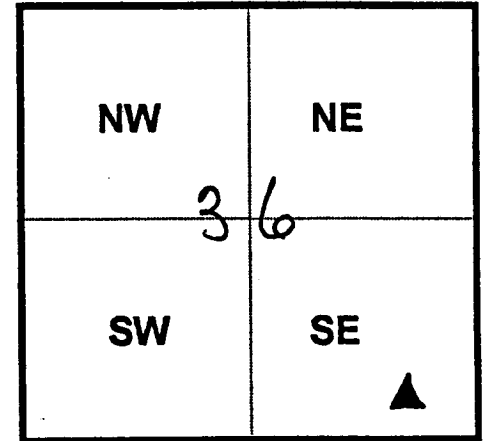

Order of Control 1<sup>ST</sup>  -Meters  - Feet Zone: IL WEST

County Coordinates: N: 639348.773 LAT: 42 25 08.61500 N

H. Datum: NAD 83/91 E: 800389.222 LON: 88 56 48.76996 W

V. Datum: NAVD 88 ELEV: 274.720 ELLIP 241.130 GH '99 -33.59

Sky Plot

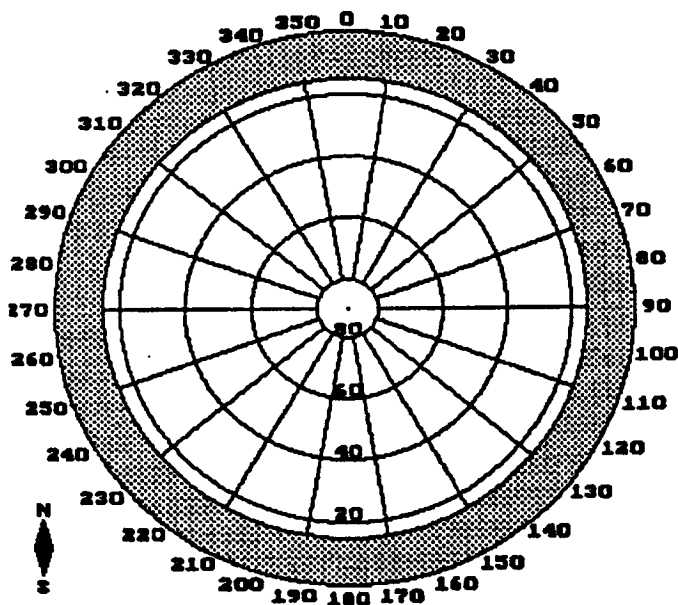

Sketch

NORTH

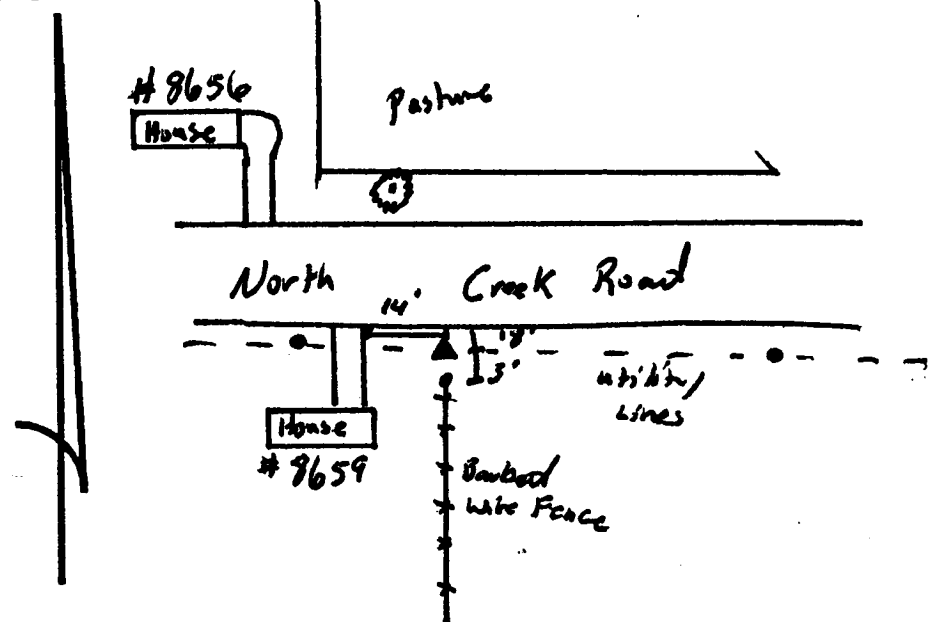

Not To Scale

Quad. Map \_\_\_\_\_  
Photo No. \_\_\_\_\_

DESCRIPTION: Station is 14 feet east of the East Edge of Pavement of Drive way to House #8659, 18 feet South of EOP of North Creek Road, and one foot North of an orange Corsonite witness post, and 3 feet North of a wood corner post to fence line.