

**Winnebago County, IL  
GPS PROJECT 2000**

Station Name WIN07.7N-06.7E Station No. 0044

Section 25, Town 44 North, Range 1  East  West

Town of WIN ROCHFORD, County Winnebago, State Illinois

Observer D. MUEHLA; Date of observation 10.25.2000

Order of Control 1<sup>ST</sup>  -Meters  -Feet Zone: IL WEST

County Coordinates: N: 621593.986 LAT: 42 15 37.43317 N

H. Datum: NAD 83/91 E: 791009.154 LON: 89 03 49.06519 W

V. Datum: NAVD 88 ELEV: 222.240 ELLIP: 188.920 GH '99 -33.32

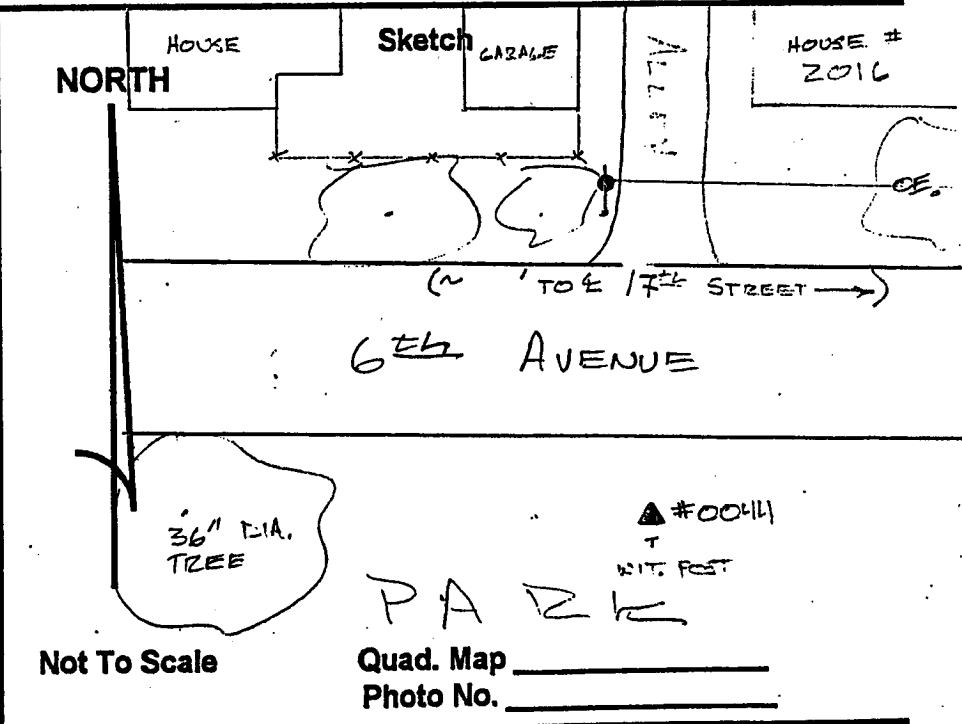
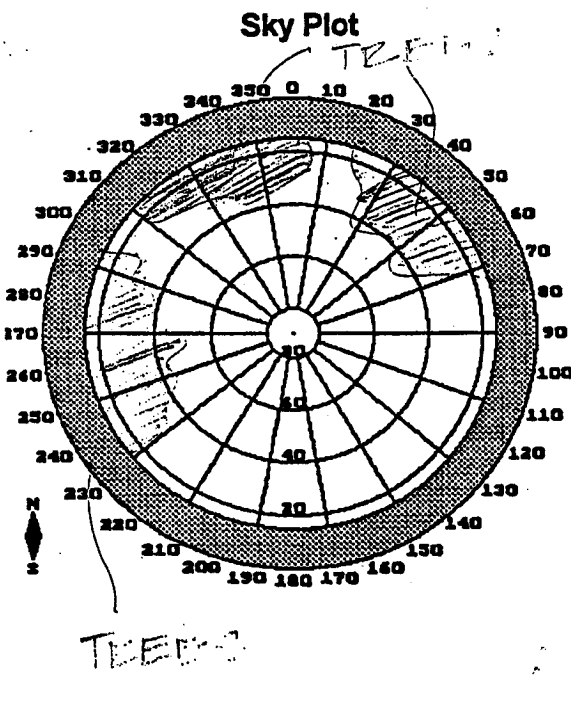
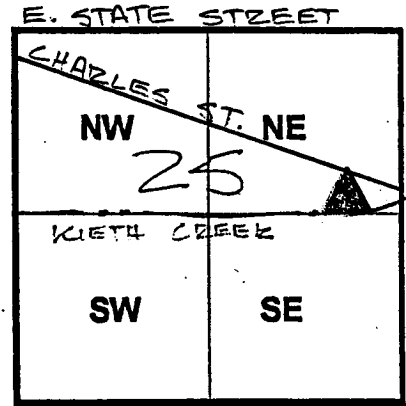

**DESCRIPTION:** POINT 0044 IS A STAINLESS STEEL ROD IN A PVC HAND-BOLE SET 40.15' BLW. GND. LOCATED ~ 25' S/O & 6th AVE. ~ 145' W/O & 17th ST. ~ 98' E/O 36' TREE ~ 1.0' N/O A CARBONITE WIT. POST.