

**Winnebago County, IL
GPS PROJECT 2000**

Station Name WIN 22.6N-01.9E Station No. 0060

Section 9 Town 46 North, -Range 1 East West

Town of ROCKTON County Winnebago State Illinois

Observer D. MUENCH ; Date of observation 10.12.2000

Order of Control 1ST -Meters -Feet Zone: IL WEST

County Coordinates: N: 645531.186 LAT: 42 28 35.74640 N

H. Datum: NAD 83/97 E: 784552.809 LON: 89 08 18.09305 W

V. Datum: NAVD 88 ELEV: 223.030 ELLIP 189.400 GH '99 -33.63

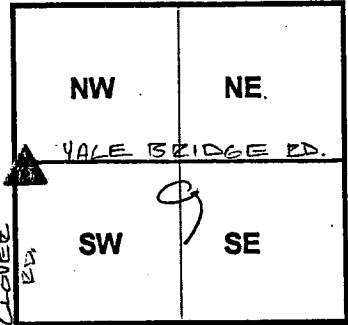

Sky Plot

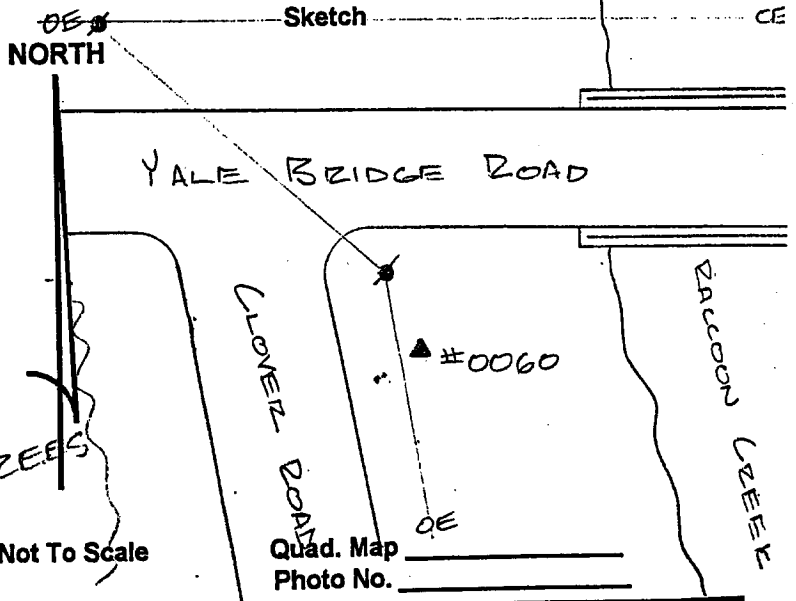
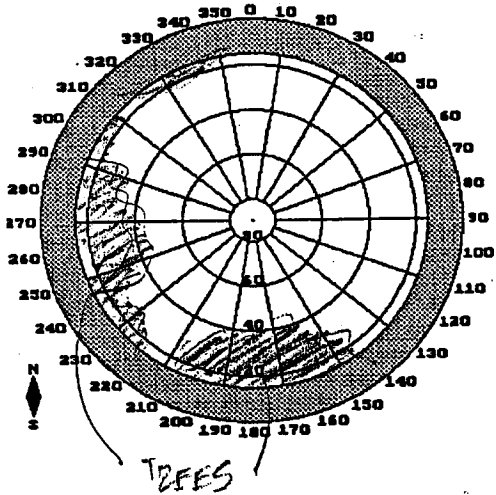

DESCRIPTION: POINT 0060 IS A STAINLESS STEEL ROD SET 0.1' BLM. GZD. IN A HAND-HOLE, LOCATED 240' E/O CLOVER RD, 251' S/O E YALE BRIDGE RD.