

Station No. \_\_\_\_\_

**Winnebago County, IL  
GPS PROJECT 2000**

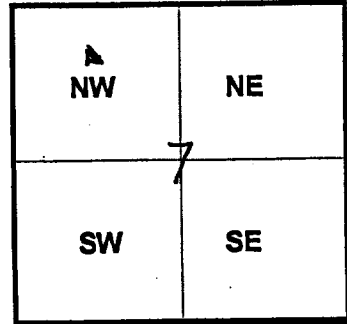

Station Name Win 04.7N12.2E Station No. 7

Section 7, Town 43 North, -Range 3 East / ~~West~~

Town of Flora, County Boone Winnebago, State Illinois

Observer C. SANDNES; Date of observation 25 OCT 2000

Order of Control 1<sup>ST</sup>  Meters  - Feet Zone: IL WEST

County Coordinates: N: 617014.127 LAT: 42 13 04.28911 N

H. Datum: NAD 83/91 E: 801676.056 LON: 88 56 06.63000 W

V. Datum: NAVD 88 ELEV: 228.870 ELLIP 195.550 GH '99 -33.32

Sky Plot

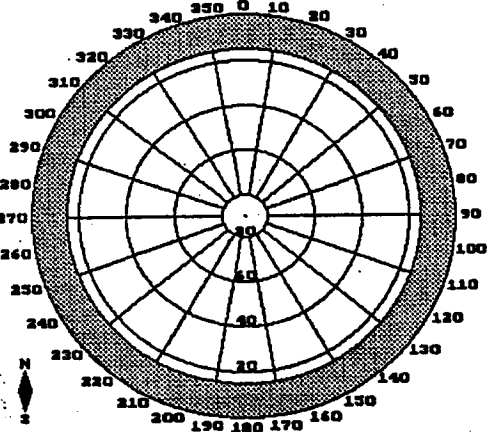

CLEAR

NORTH



Not To Scale

Sketch

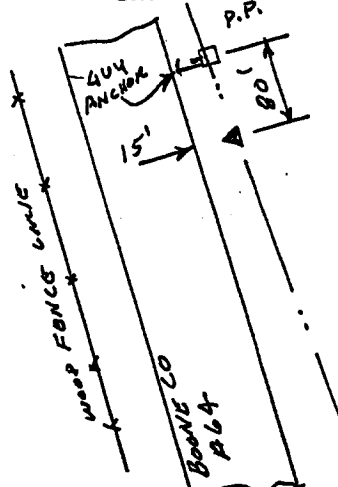

Quad. Map \_\_\_\_\_  
Photo No. \_\_\_\_\_

DESCRIPTION: SET STEEL ROD IN ACCESS BOX 0.44 MILES SE OF CHERRY VALLEY CITY LIMIT ALONG BOONE CO. ALA. 80 ft Southeast of Power Pole w/ Guy Anchor, 15ft East of East edge of curb; 1ft. West of orange concrete with post.