

**Winnebago County, IL
GPS PROJECT 2000**

Station Name WIN 02.6N-01.0E Station No. 007Z

Section 20, Town 43 North, Range 1 East / West

Town of SIN ZOCKFORD, County Winnebago, State Illinois

Observer D. MUEENCH; Date of observation 10.24.2000

Order of Control 1ST -Meters -Feet Zone: IL WEST

County Coordinates: N: 613243.345 LAT: 42 11 09.74637 N
 E: 783738.502 LON: 89 09 10.58188 W
 H. Datum: NAD 83/91 ELEV: 214.700 GH '99 -33.16
 V. Datum: NAVD 88 ELLIP: 181.540

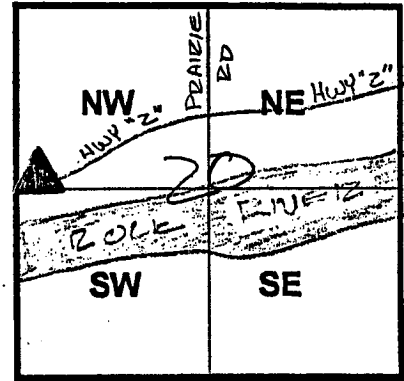

Sky Plot

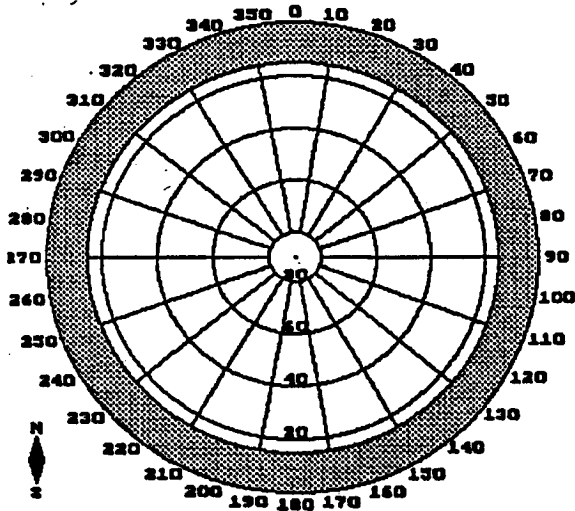

CLEAR

Sketch

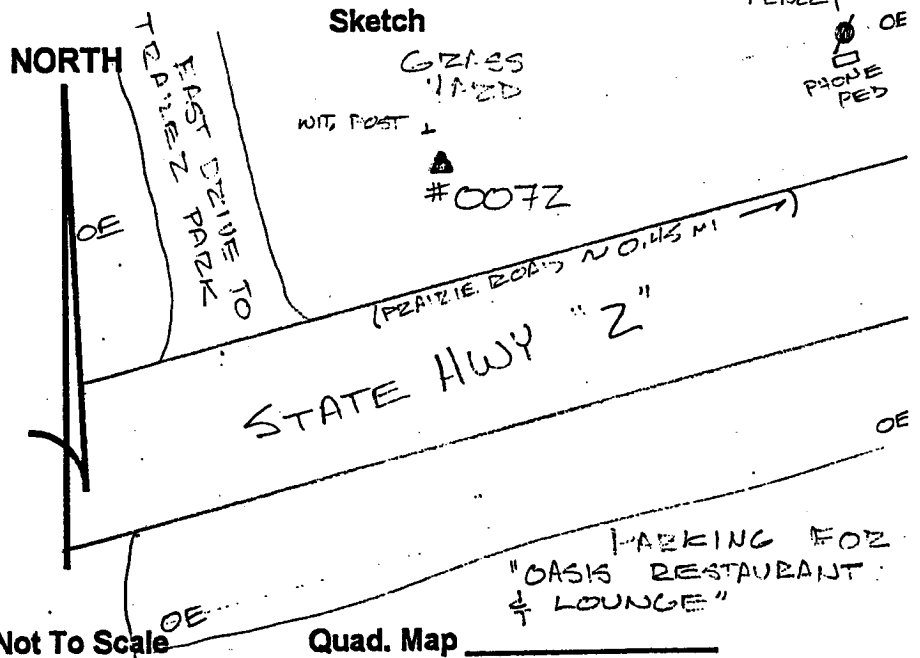

Not To Scale

Quad. Map _____
Photo No. _____

DESCRIPTION: POINT 007Z IS A STAINLESS STEEL ROD SET 0.1' DIA. GRD. IN A PVC HAND-HOLE, LOCATED 32' N/O STATE HWY "2" ~0.45 MILE W/O PEAIZIE RD, ~40' E/O & EAST DRIVE TO TRAILER PARK, & 1' S/O CARSONITE WITNESS POST.